



Refletir
PELÍCULAS

Reflectiv[®]
Window Films

CATALOGUE 2024
DECORATIVE FILMS

OUR RANGE OF

DECORATIVE FILMS

Degressive white / frosted / metallic

p. 4-20

Ligns

p. 21-35

Blackout patterns

p. 36-85

Geometric patterns

p. 86-88

INT 129



SEE TECHNICAL
DATA SHEET

INT 139

SEE TECHNICAL
DATA SHEET

INT 121

SEE TECHNICAL
DATA SHEET



INT 120



SEE TECHNICAL
DATA SHEET

INT 122

SEE TECHNICAL
DATA SHEET

INT 128



SEE TECHNICAL
DATA SHEET

INT 110

SEE TECHNICAL
DATA SHEET



INT 115

SEE TECHNICAL
DATA SHEET

INT 123



SEE TECHNICAL
DATA SHEET



SEE TECHNICAL
DATA SHEET

INT 126



SEE TECHNICAL
DATA SHEET



SEE TECHNICAL
DATA SHEET

INT 130

SEE TECHNICAL
DATA SHEET



INT 132

SEE TECHNICAL
DATA SHEET

INT 140

SEE TECHNICAL
DATA SHEET



INT 142

SEE TECHNICAL
DATA SHEET

INT 138

SEE TECHNICAL
DATA SHEET





SEE TECHNICAL
DATA SHEET

INT 236



SEE TECHNICAL
DATA SHEET

INT 237



SEE TECHNICAL
DATA SHEET

INT 560



SEE TECHNICAL
DATA SHEET

INT 212



SEE TECHNICAL
DATA SHEET

INT 213



SEE TECHNICAL
DATA SHEET

INT 220



SEE TECHNICAL
DATA SHEET

INT 230



SEE TECHNICAL
DATA SHEET

INT 244



SEE TECHNICAL
DATA SHEET

INT 245



SEE TECHNICAL
DATA SHEET

INT 250

SEE TECHNICAL
DATA SHEET

INT 420

SEE TECHNICAL
DATA SHEET



INT 435

SEE TECHNICAL
DATA SHEET

INT 570



SEE TECHNICAL
DATA SHEET





INT 610

SEE TECHNICAL
DATA SHEET

INT 880

SEE TECHNICAL
DATA SHEET



INT 860

SEE TECHNICAL
DATA SHEET

INT 276

SEE TECHNICAL
DATA SHEET





SEE TECHNICAL
DATA SHEET

INT 288



SEE TECHNICAL
DATA SHEET

INT 300



SEE TECHNICAL
DATA SHEET

INT 333

SEE TECHNICAL
DATA SHEET



INT 363



SEE TECHNICAL
DATA SHEET

INT 290

SEE TECHNICAL
DATA SHEET



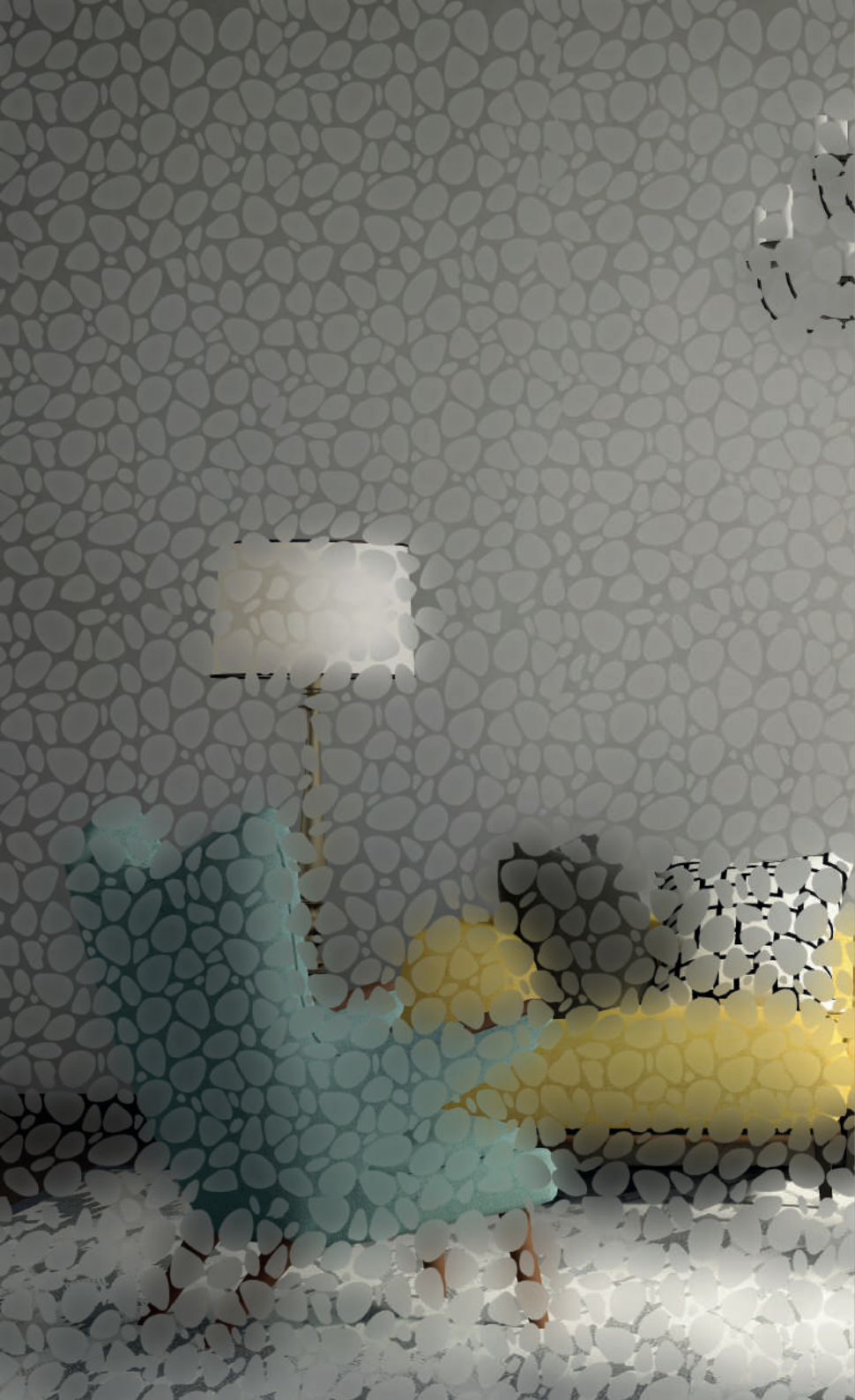

INT 320

SEE TECHNICAL
DATA SHEET

INT 450



SEE TECHNICAL
DATA SHEET

INT 460



SEE TECHNICAL
DATA SHEET

INT 520

SEE TECHNICAL
DATA SHEET



INT 470



SEE TECHNICAL
DATA SHEET

INT 480

SEE TECHNICAL
DATA SHEET



INT 490



SEE TECHNICAL
DATA SHEET

INT 491



SEE TECHNICAL
DATA SHEET

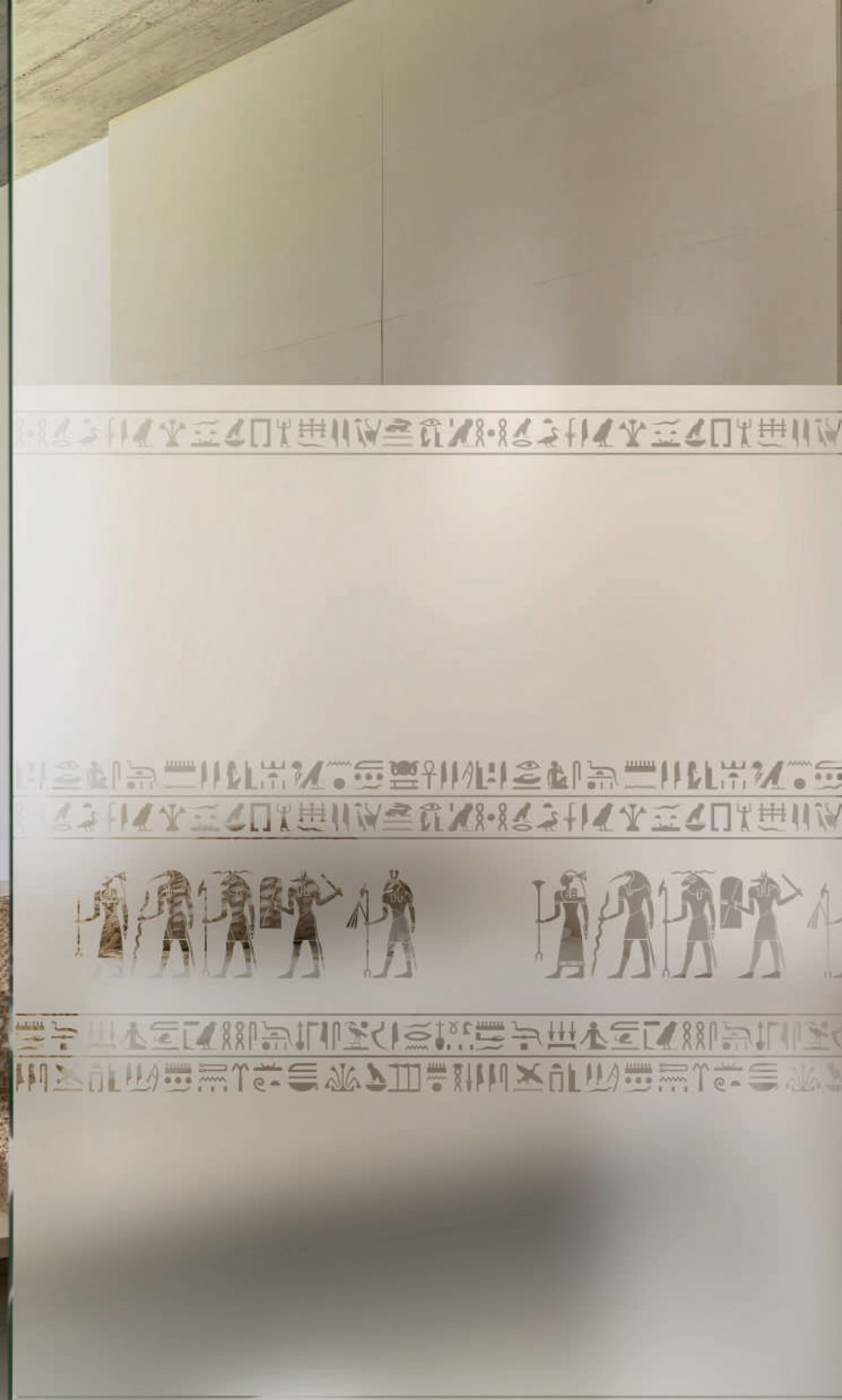

INT 496

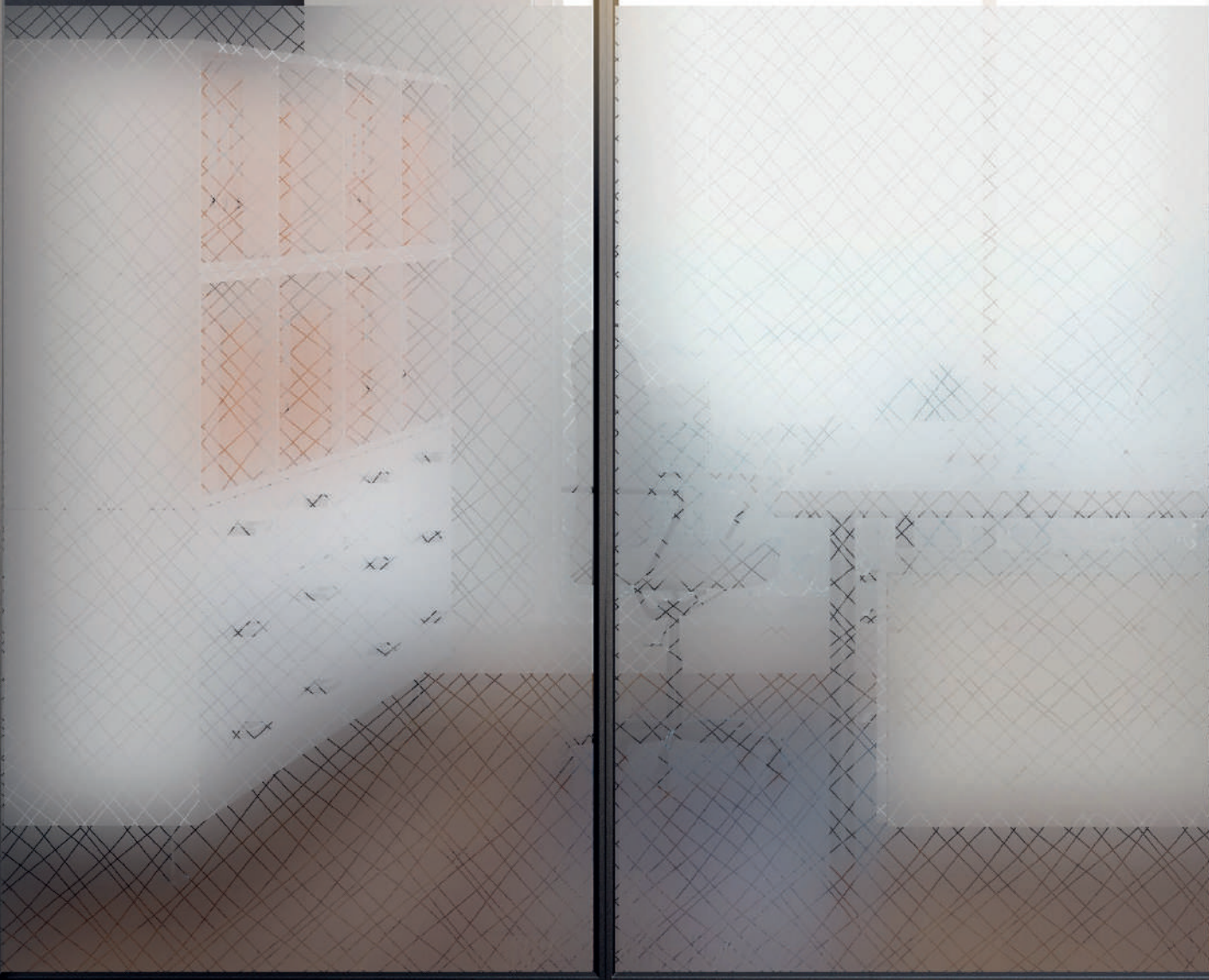

SEE TECHNICAL
DATA SHEET

INT 468



SEE TECHNICAL
DATA SHEET

INT 538



SEE TECHNICAL
DATA SHEET

INT 540



SEE TECHNICAL
DATA SHEET

INT 549



SEE TECHNICAL
DATA SHEET

INT 780



SEE TECHNICAL
DATA SHEET



INT 792

SEE TECHNICAL
DATA SHEET

INT 861



SEE TECHNICAL
DATA SHEET

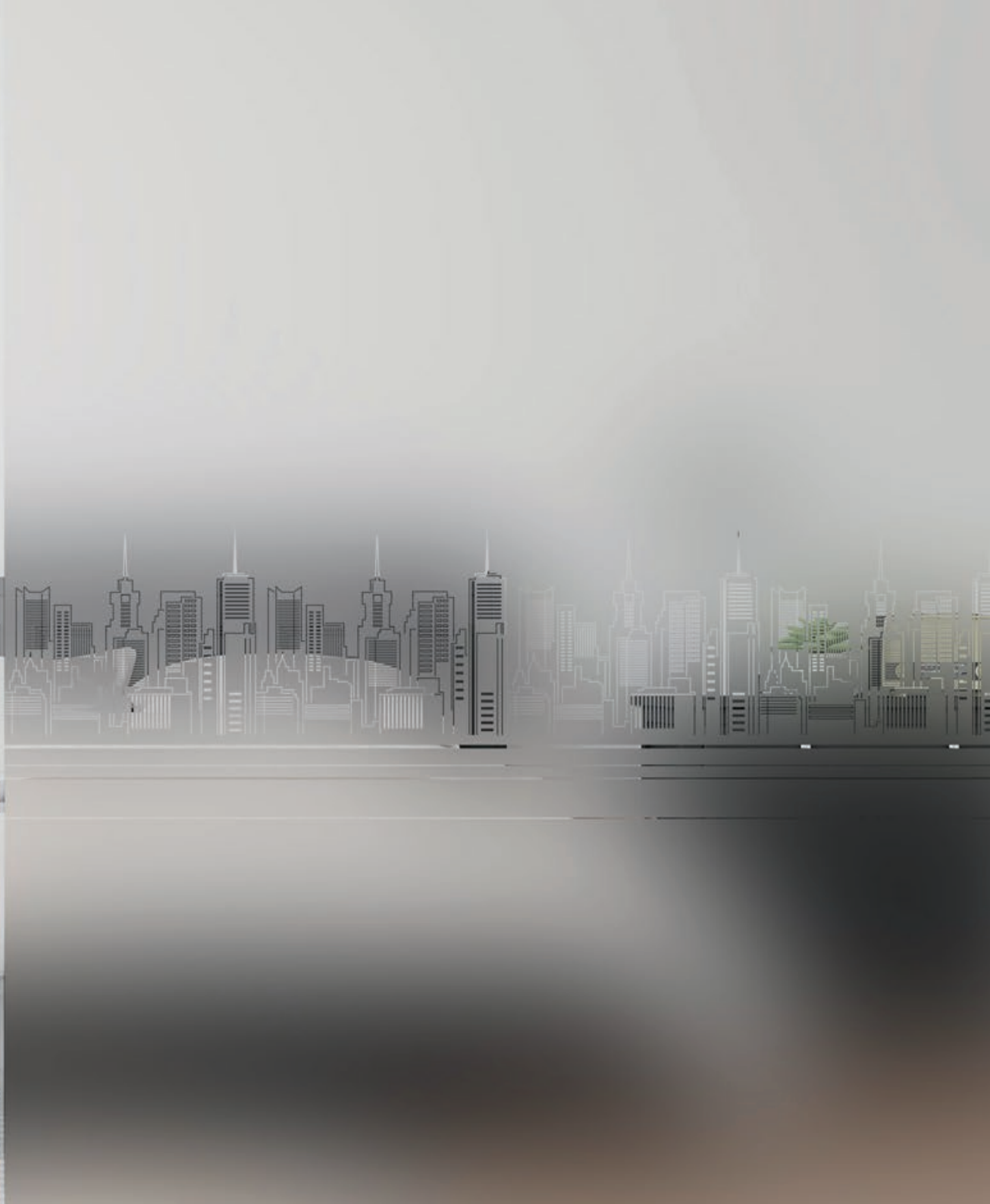



INT 864



SEE TECHNICAL
DATA SHEET

INT 940



SEE TECHNICAL
DATA SHEET

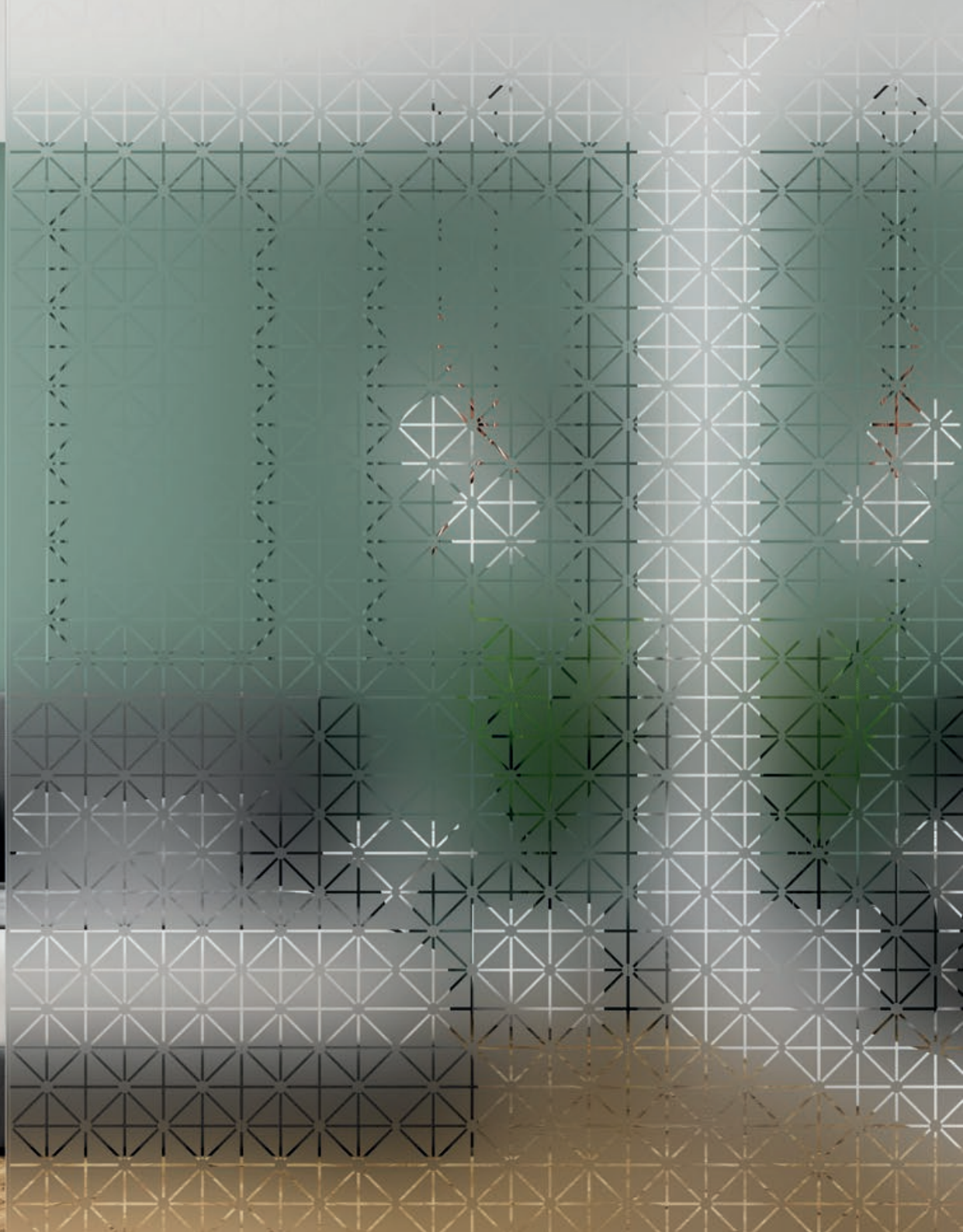

INT 150



SEE TECHNICAL
DATA SHEET

INT 343

SEE TECHNICAL
DATA SHEET



INT 353



SEE TECHNICAL
DATA SHEET

INT 478



SEE TECHNICAL
DATA SHEET



SEE TECHNICAL
DATA SHEET

INT 500



SEE TECHNICAL
DATA SHEET

INT 528



SEE TECHNICAL
DATA SHEET

INT 510



SEE TECHNICAL
DATA SHEET



INT 528



SEE TECHNICAL
DATA SHEET

INT 529



SEE TECHNICAL
DATA SHEET



SEE TECHNICAL
DATA SHEET

INT 710



SEE TECHNICAL
DATA SHEET



INT 730



SEE TECHNICAL
DATA SHEET

INT 710



SEE TECHNICAL
DATA SHEET



INT 790



SEE TECHNICAL
DATA SHEET

INT 793



SEE TECHNICAL
DATA SHEET

INT 539



SEE TECHNICAL
DATA SHEET

INT 530

SEE TECHNICAL
DATA SHEET





SEE TECHNICAL
DATA SHEET

INT 535



SEE TECHNICAL
DATA SHEET

INT 537



SEE TECHNICAL
DATA SHEET

INT 534



SEE TECHNICAL
DATA SHEET

INT 536



SEE TECHNICAL
DATA SHEET

INT 770

SEE TECHNICAL
DATA SHEET





INT 380

SEE TECHNICAL
DATA SHEET

INT 782



SEE TECHNICAL
DATA SHEET

STR 01

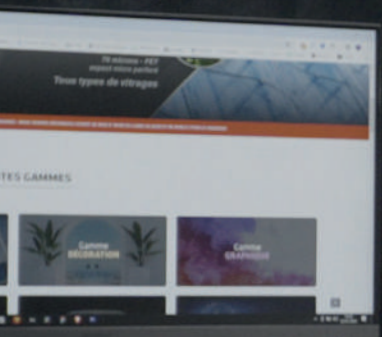

SEE TECHNICAL
DATA SHEET

STR 02

SEE TECHNICAL
DATA SHEET

STR 04

SEE TECHNICAL
DATA SHEET

STR 05



SEE TECHNICAL
DATA SHEET

STR 06

SEE TECHNICAL
DATA SHEET

STR 07

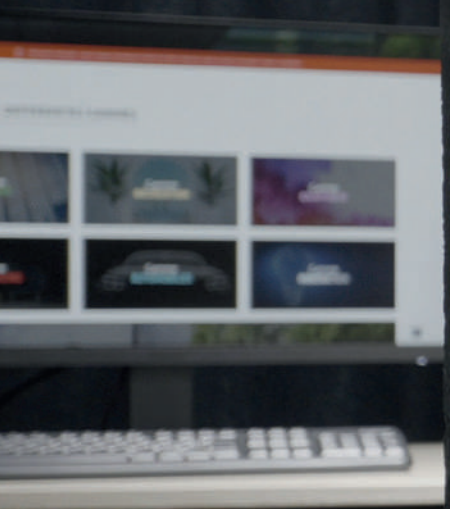

SEE TECHNICAL
DATA SHEET

STR 08

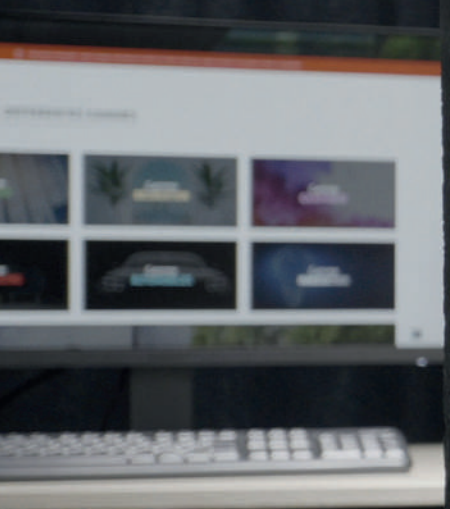

SEE TECHNICAL
DATA SHEET

TECHNICAL INFORMATION

Support :	PET
Adhesive :	Acrylic polymer 13gr/m2
Protector :	Siliconised PET 23 microns
Thickness :	23 microns
Application side :	Interior
T° of application :	min, + 5°C
Standards :	EUROCLASSES
Fire rating :	B-s1, d0
Garanty :	10 years indoors if not exposed to sunlight

PRODUCTION MONITORING AND STANDARDS

In order to constantly improve our products, we may modify colours and manufacturing processes without prior notice. Before applying our films, we recommend that users ensure that they are suitable for the intended use and comply with current standards.

APPLICATION ADVICE

To install, use soapy water and suitable tools.

RECOMMENDATIONS

The surface must be clean and covered with soapy water before application. For best results, use the appropriate equipment. Some materials, such as polycarbonate, can generate bubbles. To meet the highest standards, we recommend that you do not mix films from different productions.

 **DURABILITY :** 10 years for vertical applications in Central Europe.

 **USE :** For all types of glass

 **MAINTENANCE :** After 30 days with a standard cleaning solution (non-abrasive, ammonia-free, etc.). Do not use cleaning products that could scratch the surface.

 **STORAGE :** 2 years from delivery. This film should be stored away from excessive moisture and sunlight, at a temperature below 38°C.

Available in roll sizes : 1,52m | 10 m
30 m

Refletir

PELÍCULAS



praceta salgado zenha, nº3, loja 1
urbanização de santo andré - flamenga
2660-328 santo antónio dos cavaleiros

t. +351 218 109 055 | t. +351 218 941 100
info@refletir-peliculas.pt
www.refletir-peliculas.pt